



Bending Solutions in *Automotive*



Boru ve Profil Bükümünde Lider
Leader in Tube and Profile Bending

Who are we?

We are a young and dynamic company that aims for continuous success with the support of our employees who have great experience in bending and shaping pipes, profiles and metal sheets.

Our technical expertise and production capacity allow us to provide our customers with quality products on time and at competitive prices.

Our company, established in Bursa, the heart of Turkish industry, successfully serves foreign markets as well as all of Turkey at an international level.

Vision & Corporate Value

Vision:

- # To lead in engineering and customer satisfaction
- # To act with integrity to our customers and partners
- # To care for our employees

Corporate Value :

INNOVATION : We believe that progress is achieved through continuous innovation. AVERA takes great pride in creating an environment where all employees can grow, flourish and explore their potential.

INTEGRITY : Integrity represents our corporate and one of most critical philosophies of AVERA. We abide by the highest standards of honesty and transparency.

SOCIAL CONSCIENCE : At AVERA, we treat our staff as family. We believe that our success is a product of our employees and partners efforts / contributions. We endeavor in giving back to our communities.

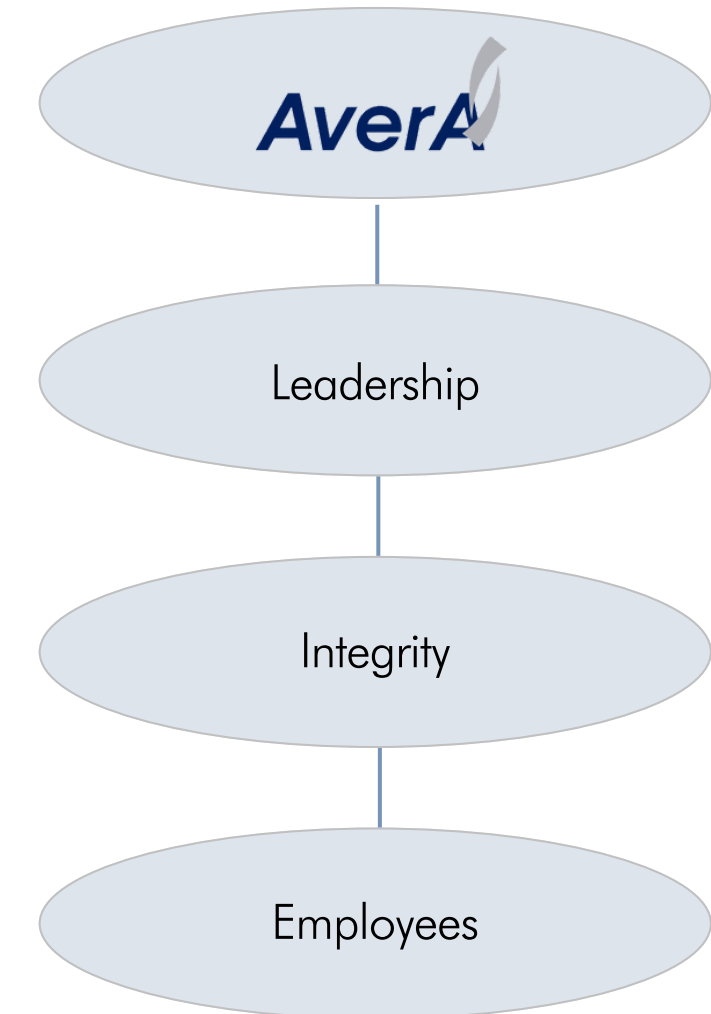

Boru ve Profil Bükümünde Lider
Leader in Tube and Profile Bending

Our Principles

Our Employees:

AVERA Büküm Sanayi ve Ticaret Limited Şirketi is committed to fairness in employment opportunities and earnings by fully embracing the cultural diversity in the communities we call “home.” The well-being and interests of our employees are our priority in every process of our business.

AVERA Büküm Sanayi ve Ticaret Limited Şirketi is committed to the following:

- Create and sustain an environment of success based on honesty and integrity,
- Ensure equitable sharing in company success,
- Empower employees through training and communication,
- Encourage individual development and equal opportunity,
- Design and provide a safe work environment.

Engineering

We interpret our bending inspection simulations using your 3D data / drawings and provide you with feedback on any problems or opportunities you may encounter.

If you are in the product development phase, we combine our experience with your design to produce your product at the quality level your customers expect without difficulty and unnecessary mold investments.

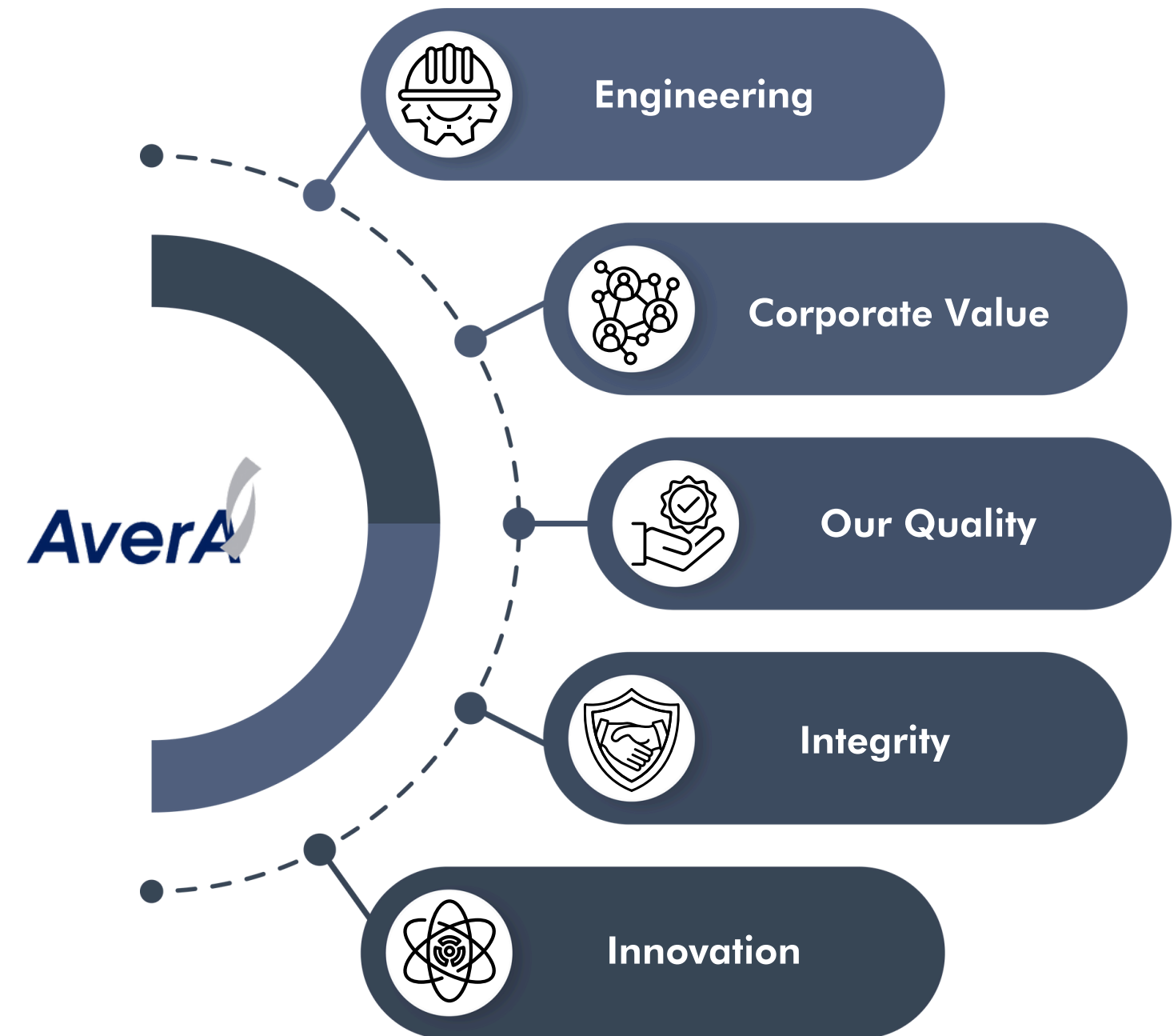

Automotive

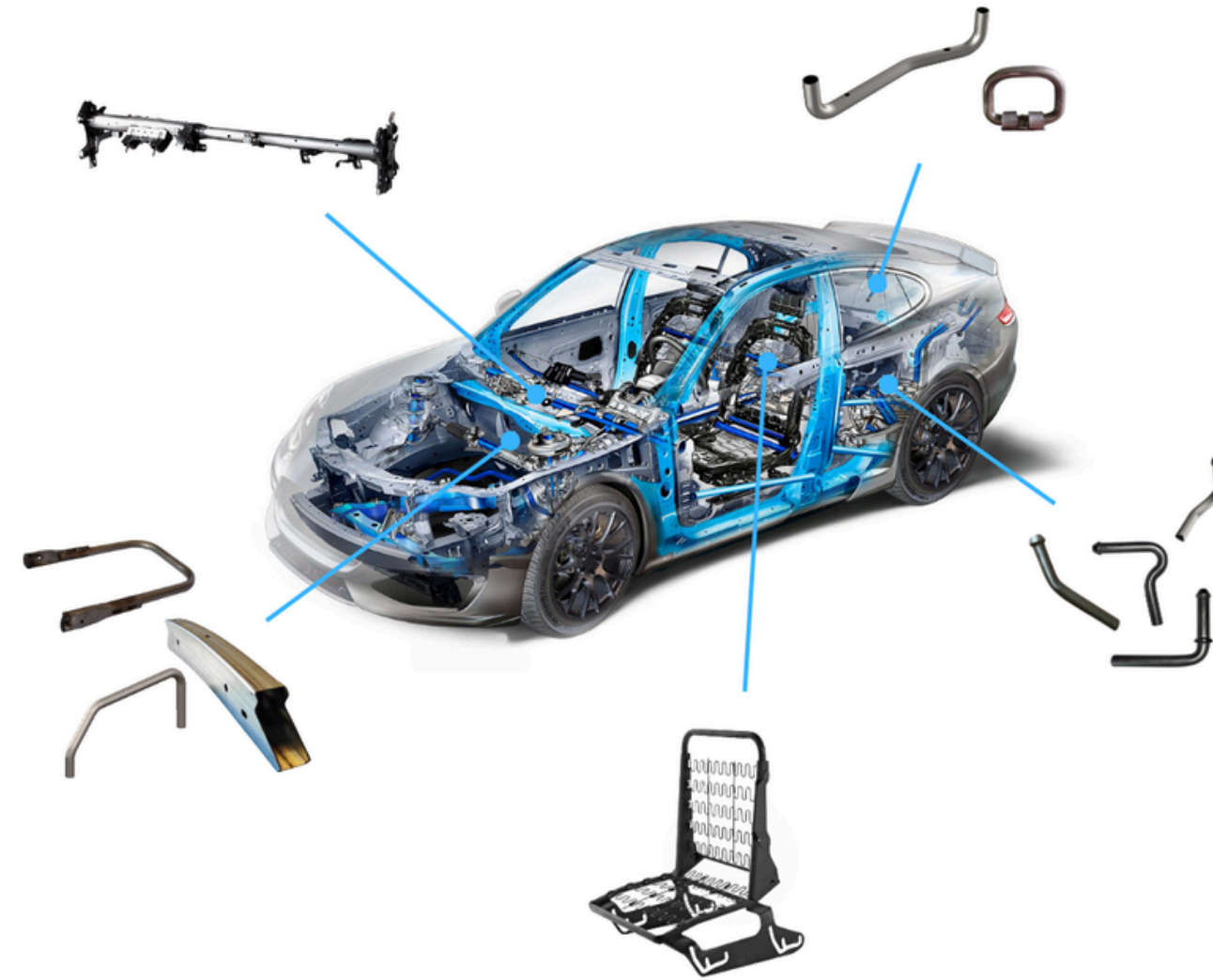

Seat frame parts, exhaust hanger hooks, dashboard cross member tubes, door reinforcement cross members for passenger and commercial vehicles are produced. At the same time, bending, press forming, end forming processes, precision hole drilling processes of bent parts, laser cutting and discharge processes and precision processes on tubes and profiles are processed. Advanced mold technologies and automation systems are used in our production processes, and each part is produced in accordance with high quality and durability standards.

Cabin

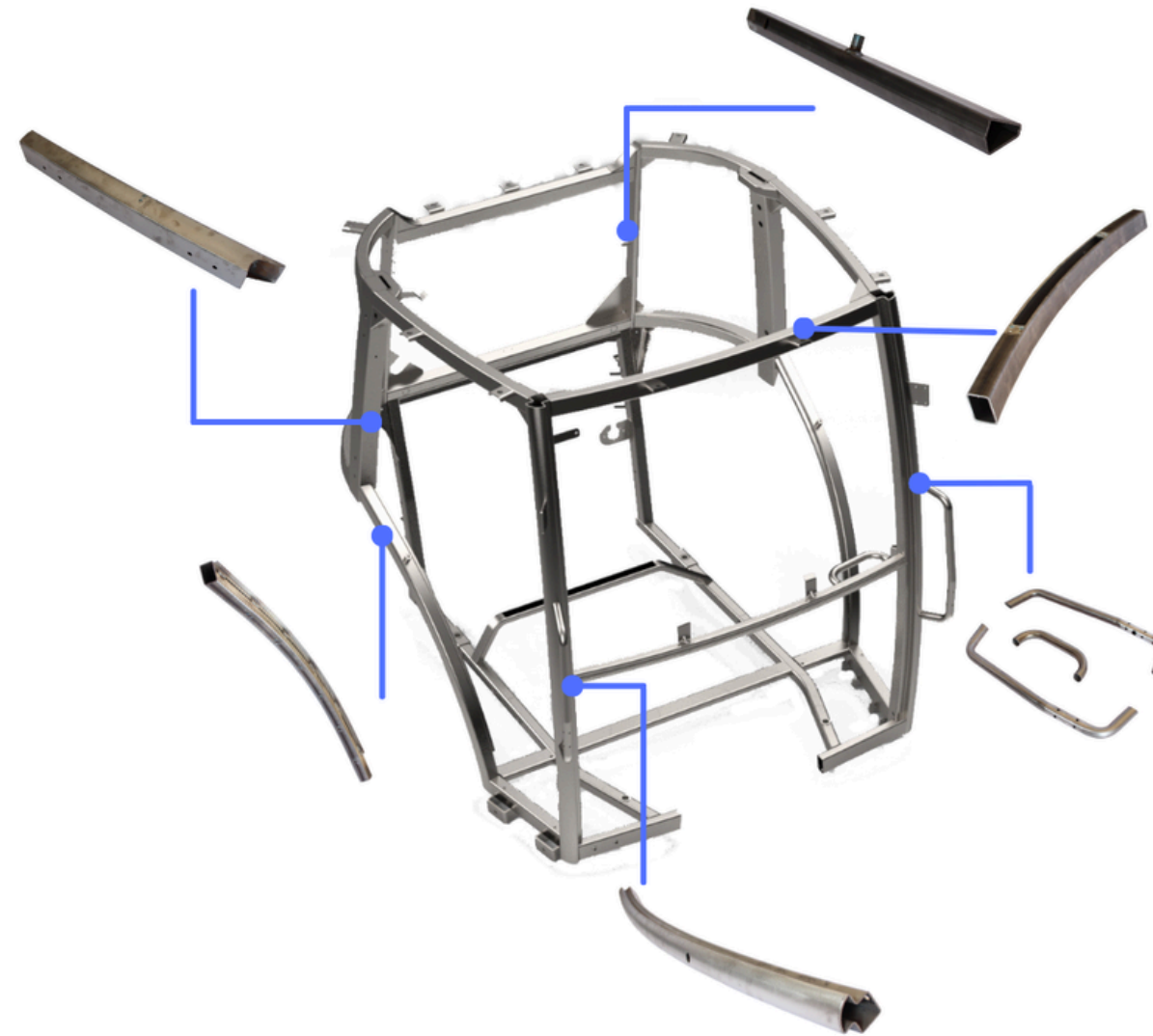

The main frame parts of tractor and construction equipment cabins are manufactured. The main body parts of the cabins produced from tubes and profiles are bent, all detailed processes are processed on the profiles (such as precision drilling, 3-axis form, angled edge processes, laser discharge and cutting) and welded and assembled. The bending and detail part process operations of the profiles of the special section OMEGA profiles used in the cabins are also carried out.

Commercial Vehicle - Minibus

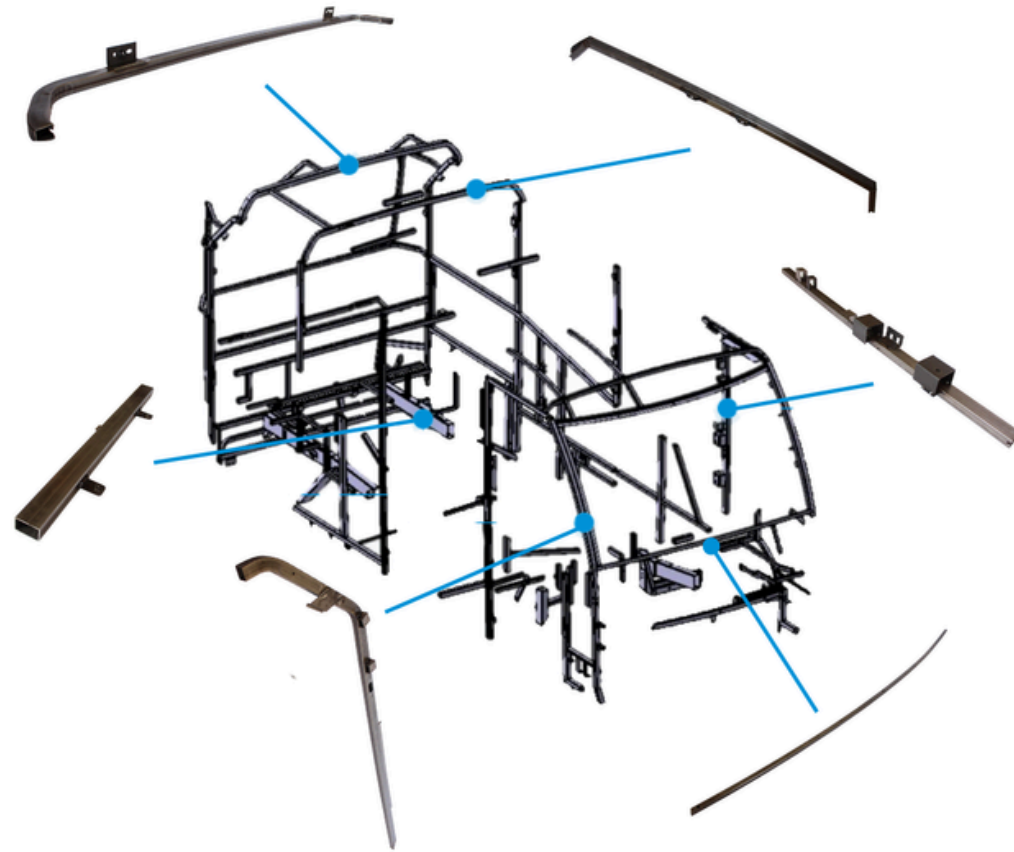

Commercial Vehicle - Bus Truck

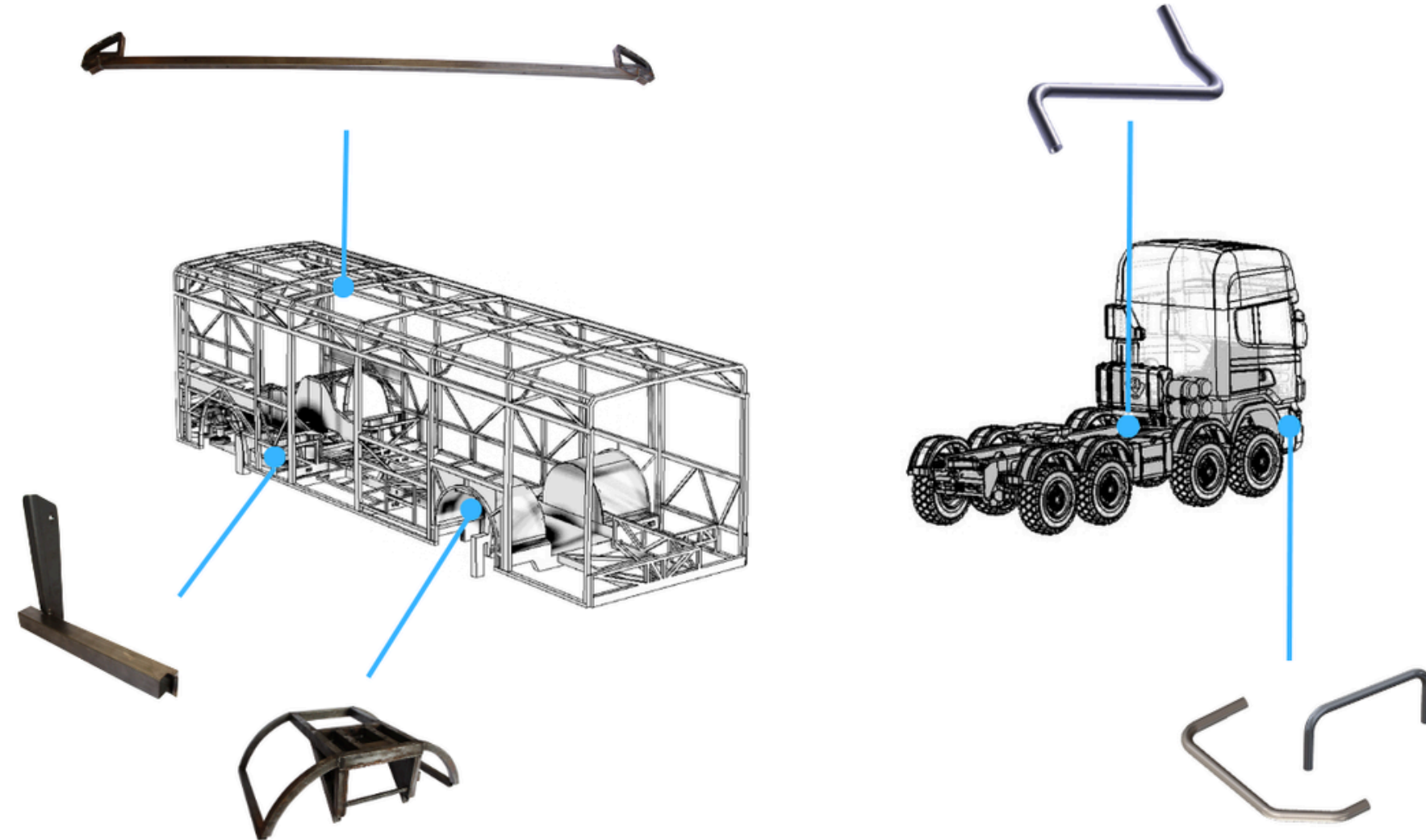

We produce detailed parts for commercial vehicles (minibuses, buses, trucks, light rail systems) whose body frames are made of tube and profile raw materials.

We produce assembled vehicle parts such as bending, shaping, laser discharge, bracket welding and riveting. In our production process, high precision machines and quality control systems are used to produce each part in accordance with the standards. By developing special solutions for customer demands, we guarantee the production of durable and long-lasting parts.

Seat Components



In line with customer demands, technical requirements, and international quality standards, we design and manufacture seat frames suitable for all vehicle segments using advanced engineering solutions and modern production technologies. By meticulously implementing quality control and verification procedures at every stage of the production process, we deliver reliable, durable, and ergonomic products.

1) Automotive

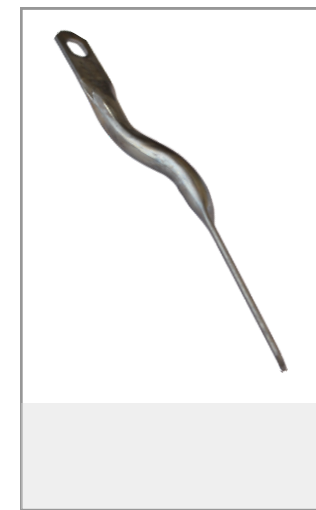
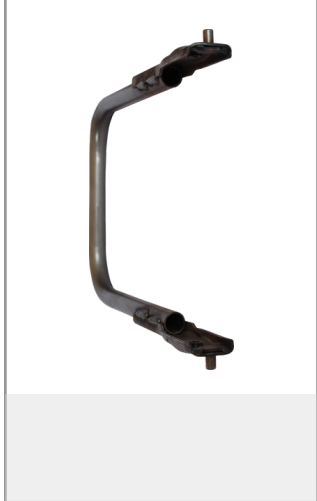
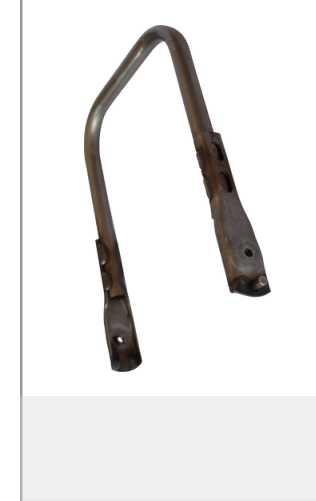
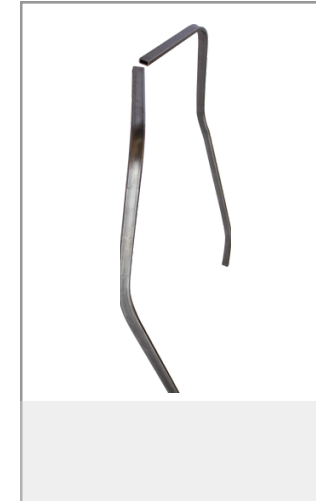
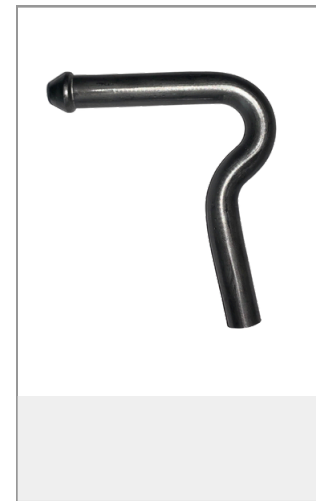
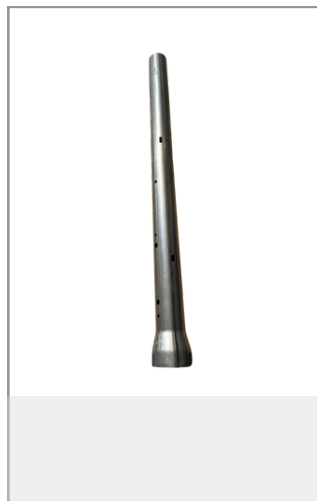
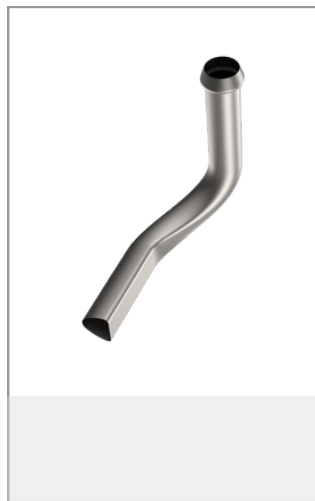
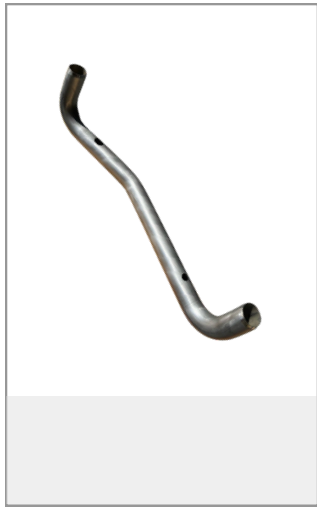
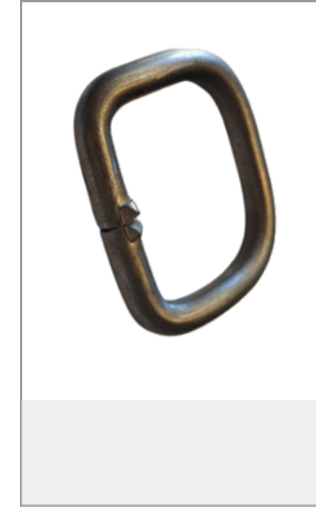
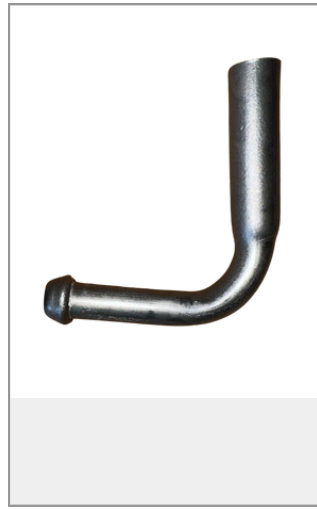
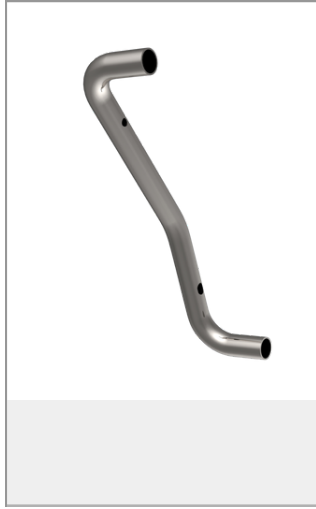
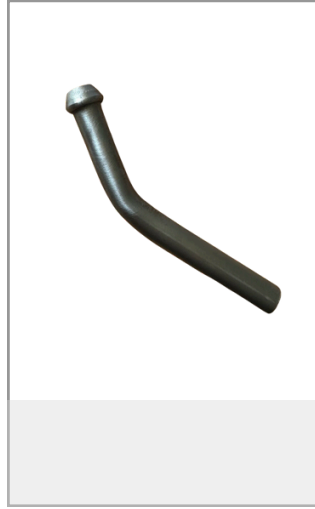
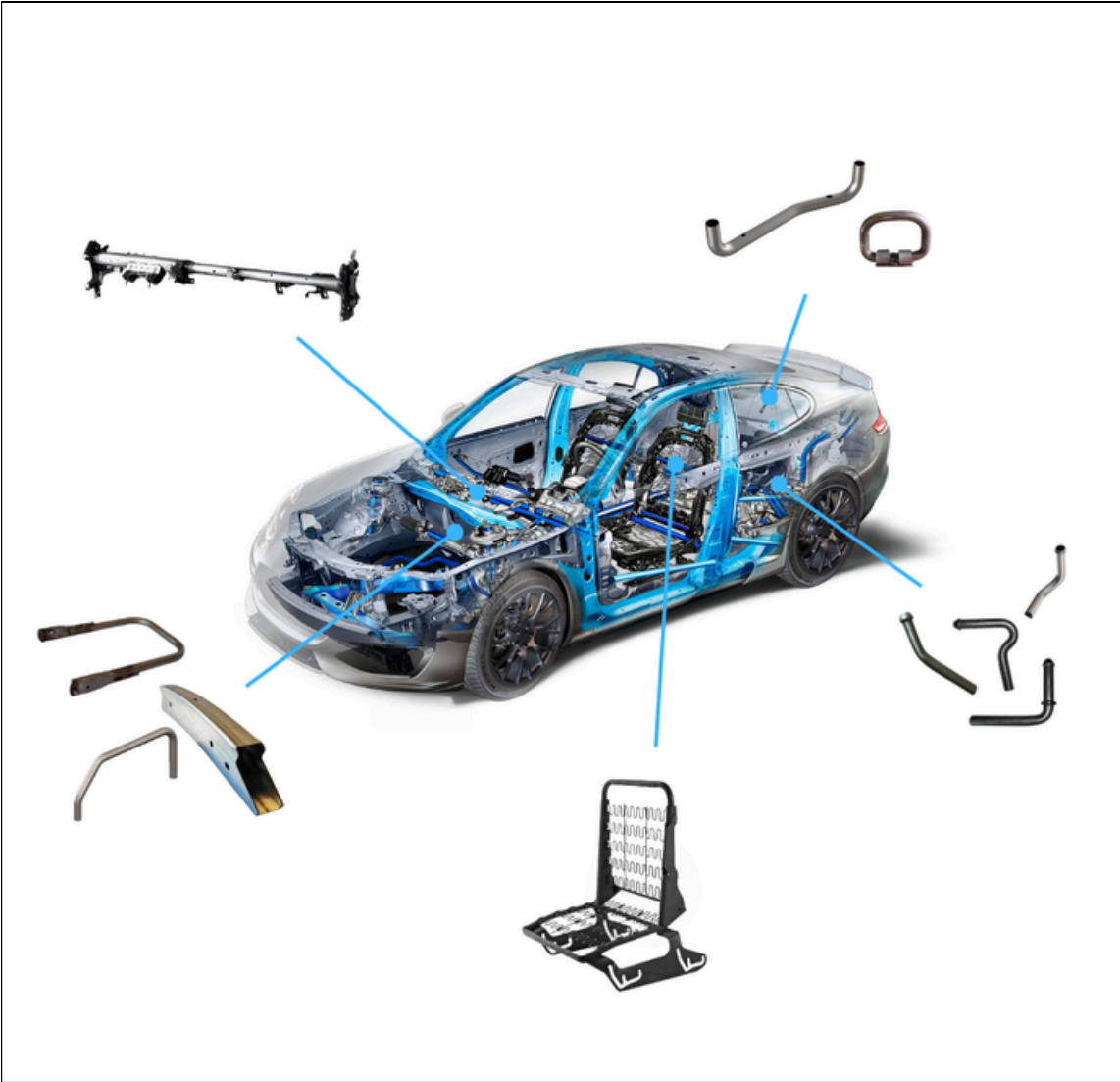

2) Cabin

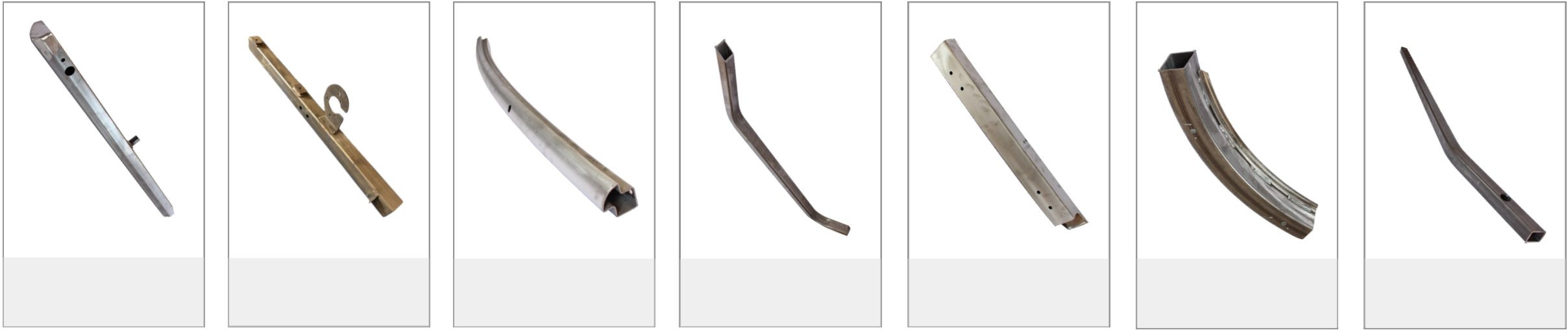
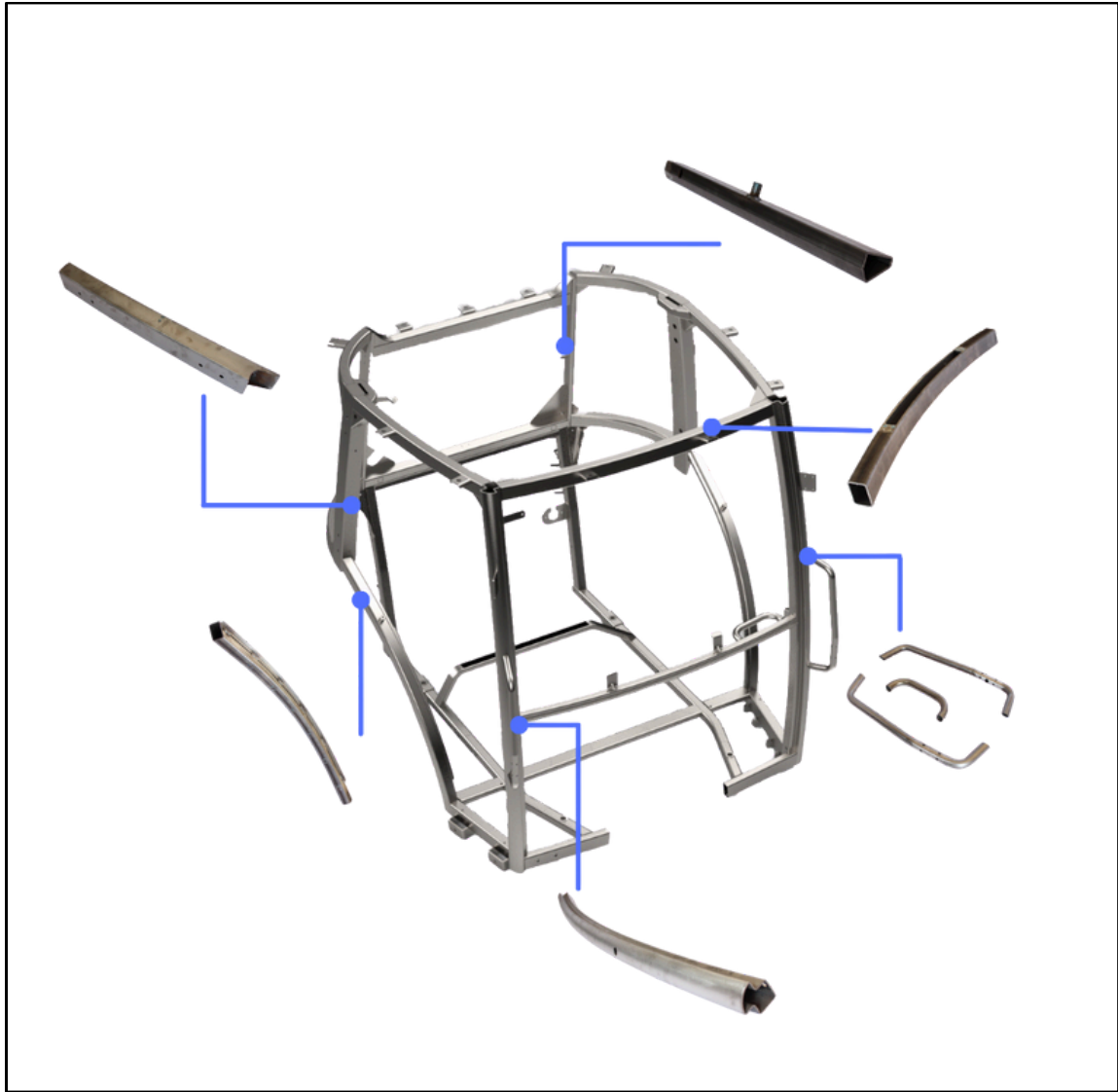

3) Commercial Vehicle (Minibus)

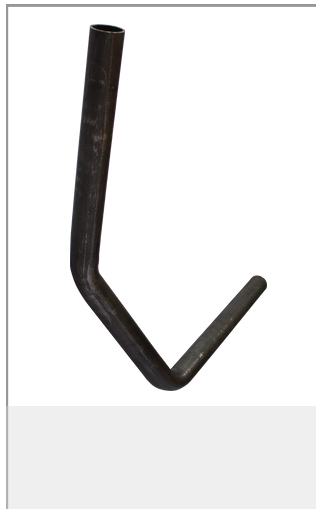
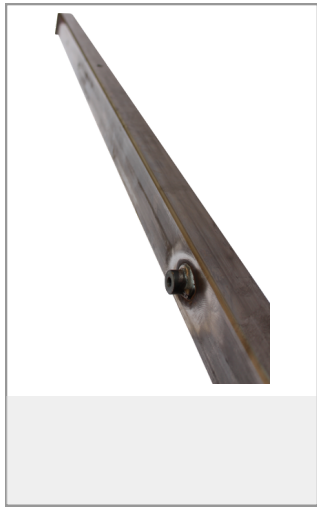
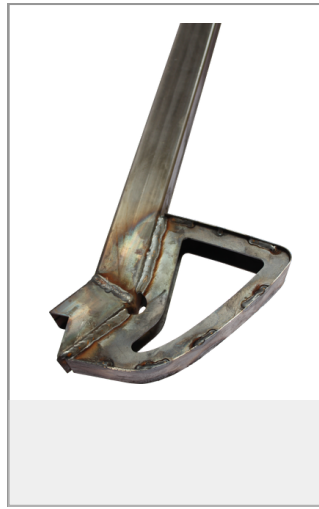
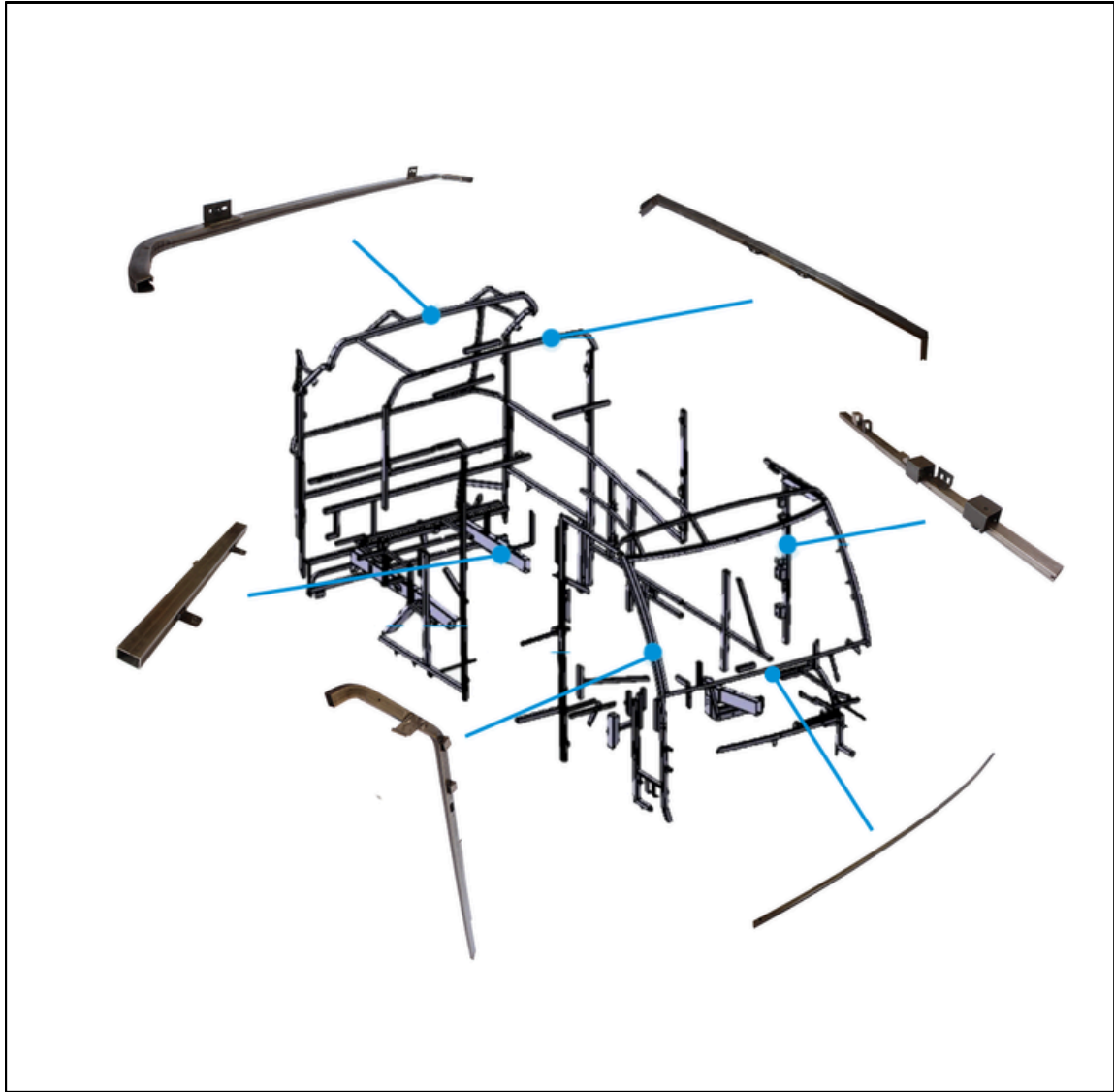

4) Commercial Vehicle (Bus-Truck)

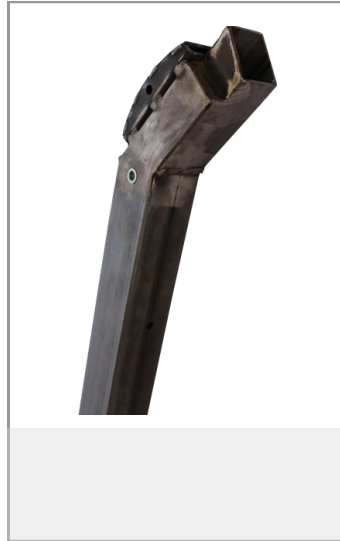
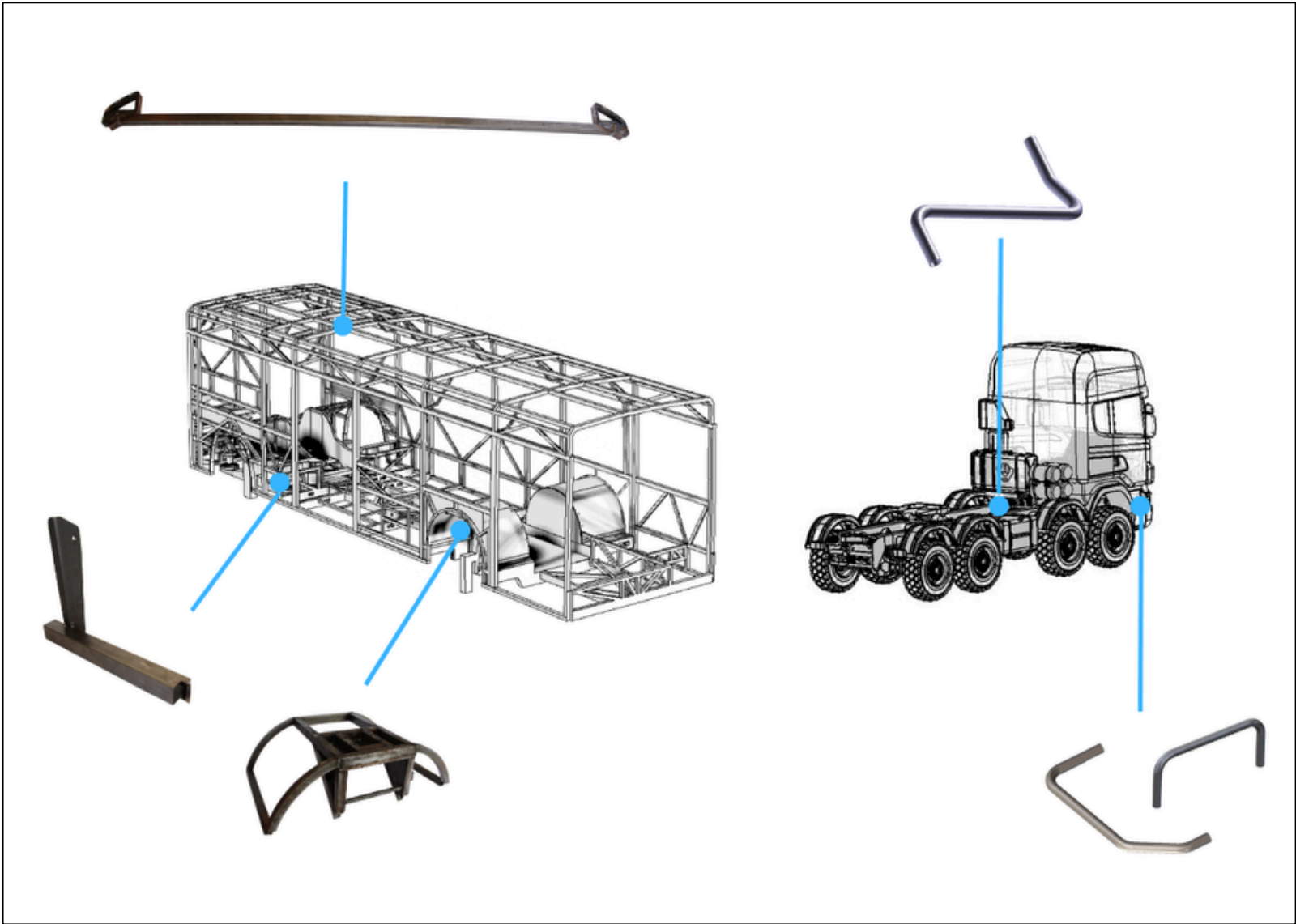

Bending

As AVERA, we create value for our customers with our wide inventory of bending molds and equipment. We shape steel, stainless steel, aluminum, alloys and tubes and profiles up to 80 mm diameter. We perform mandrel bending and roller bending according to material, size, volume and bending radius. Thanks to the various bending equipment in our machine park, we produce a wide range and high quantities. We produce turnkey projects with our own mold, welding and control apparatus design and manufacturing competence.



ABM 76

The CNC model hydraulically bends tubes up to 76 mm diameter with high quality. With the CNC feature, the bending stages can be performed automatically one after the other.



ABM 50

CNC Tube Bending Machine makes perfect bending of pipes up to 50 mm diameter.



ABM 38

With the CNC Tube Bending Machine, it achieves excellent bending results on tubes up to 38 mm diameter.



APK Small

Practical and universal rolls also bend more easily and various profiles. These machines have a three-roll drive and minimize material slippage during bending.



APK Medium

Practical and universal rolls also bend more easily and various profiles. These machines have a three-roll drive and minimize material slippage during bending.



DGM 80

With the CNC Tube Bending Machine, it achieves excellent bending results on tubes up to 80 mm diameter.



DMS 42

CNC Tube Bending Machine makes perfect bending of tubes up to 42 mm diameter.



CSR 15

CNC Tube Bending Machine makes perfect bending of tubes up to 15 mm diameter.



AVRML1

The CNC Shaft Bending Machine produced by Avera makes perfect bending up to 10 mm diameter.

Tube - Profile Processing

AVERA Bending can expand its solution platform to serial processes that will add value to your product. While 2 6-axis CNC machining centers are used for precise processes in classic parts, there are plasma cutting and drilling robots for more complex 3D holes and discharges. These equipments offer alternative solutions to our trained manpower and offer repeatability with high volume and sharp accuracy. The equipment and molds used in our robotic and manual cells are produced in our own structure in accordance with the process and quality requirements requested by the customer.

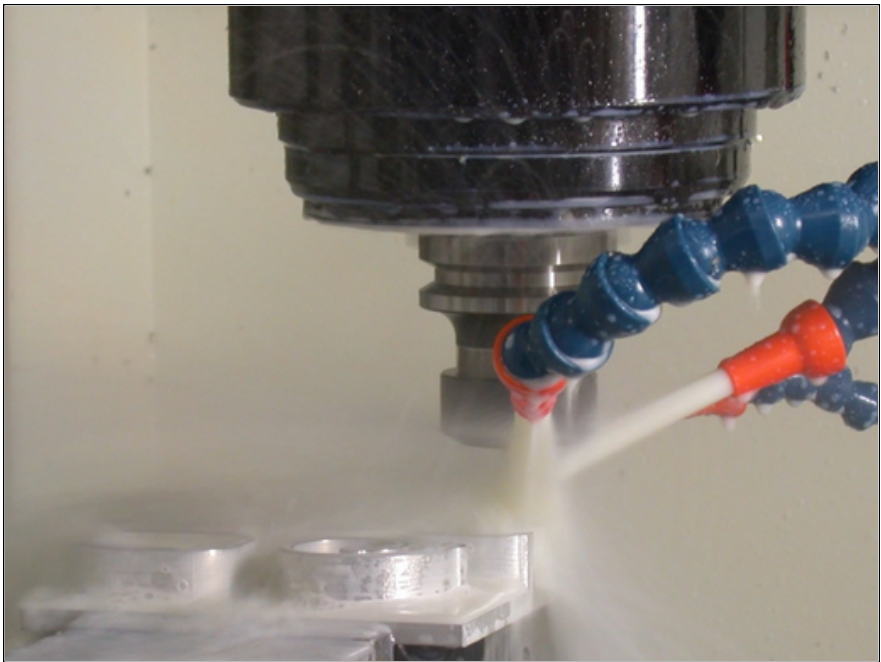

Milling cutters

It completes operations requiring high precision efficiently thanks to the programs loaded into its memory and tool changing capability.



3D Robotic Drill

Our equipment, designed to process large parts that require high hole precision and drilling after bending, helps us process parts efficiently thanks to its tool change ability.

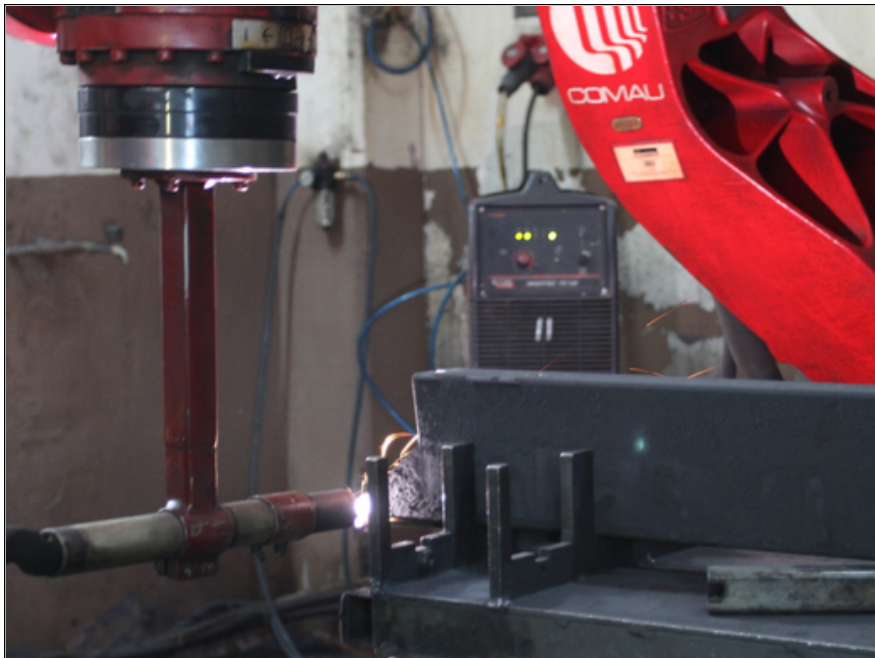

3D Robotic Plasma

It is a system that efficiently performs rough unloading and end processing needs in twisted and thick materials. It is especially effective in parabolic and 3-dimensional cutting.

Profile/Tube - Laser/Processing

With the laser cutting machines in our production line, in addition to tubes between Ø8 mm and Ø120 mm, square and rectangular profiles between 8 mm and 150 mm are cut with high precision.

Our machines operate with a positioning accuracy of 0.05 mm/m and a repositioning accuracy of 0.03 mm on the X and Y axes; thus, it allows the repeatable production of complex geometries and precise cutting details.



With its compact structure, it offers ideal performance in precise cuts, enabling tube and profile cutting up to Ø120 mm.

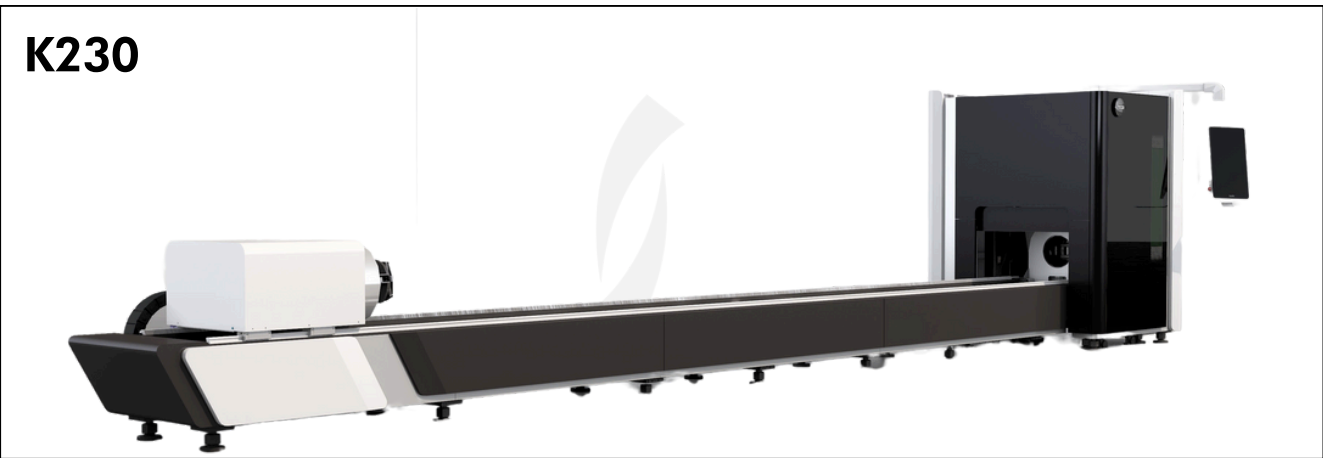

Optimized for large size parts with its high carrying capacity and wide cutting range.



In order to add more value to our products and to provide complete parts to our customers, we also provide welding services. We design manual and robotic welding processes depending on the geometric and production volume requirements of the production parts.



Static Single Fixture Robot Welding Cell

It offers high repeatability and quality welding outputs thanks to the robot that can weld long lengths without interruption.



Manual Welding Stations

In light of our experience in the automotive industry, we implement our approach focused on quality and repeatability in welded joints with our trained human resources.

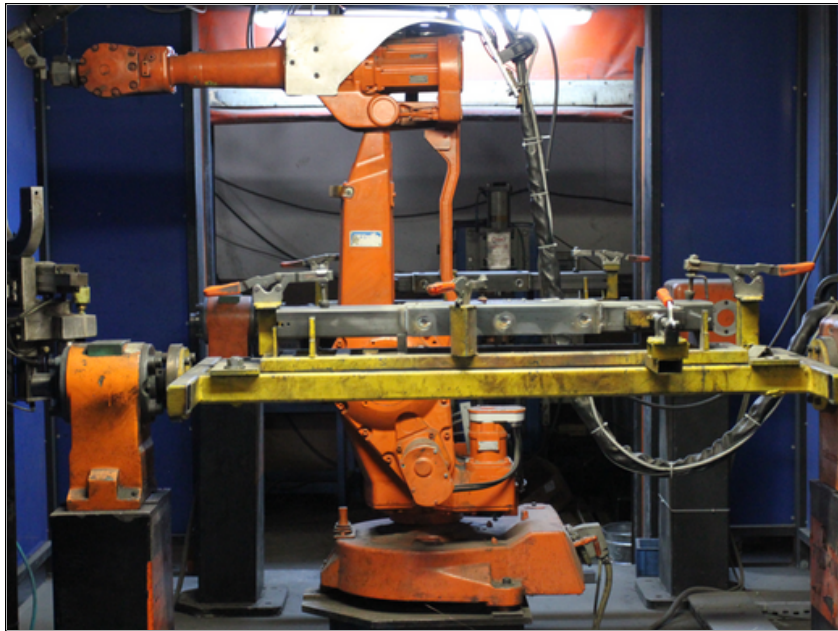

Dynamic Dual Fixture Robot Welding Cell

It offers high repeatability and quality welding outputs thanks to its robot that can weld continuously for long lengths. It can weld continuously in 3D thanks to its rotators.



Nut and Bolt Welding

We can fix the welded bolts, nuts and all kinds of mechanical fasteners on your product according to your design.

End Forming

In order to add more value to our products and to provide complete parts to our customers, we also provide welding services. We design manual and robotic welding processes depending on the geometric and production volume requirements of the production parts.

With 3 end forming machines in our production line, different forming processes are carried out for tube ends. Thanks to these machines;

- Tube expansion
- Blowing
- Tube shrinking

processes can be applied with precise tolerances. Forming processes are carried out in a controlled manner in accordance with customer technical drawings and product functions, and are carried out in an integrated manner with bending and pre/post welding processes.

Electric End Forming



Providing precision and energy efficiency with its fully electric structure, the system offers repeatable results in tube inflation and shrinkage processes.

Hydraulic End Forming



It is a reliable solution for end forming processes that performs inflation and shrinkage operations on tube ends with high precision.

Hydroforming Process

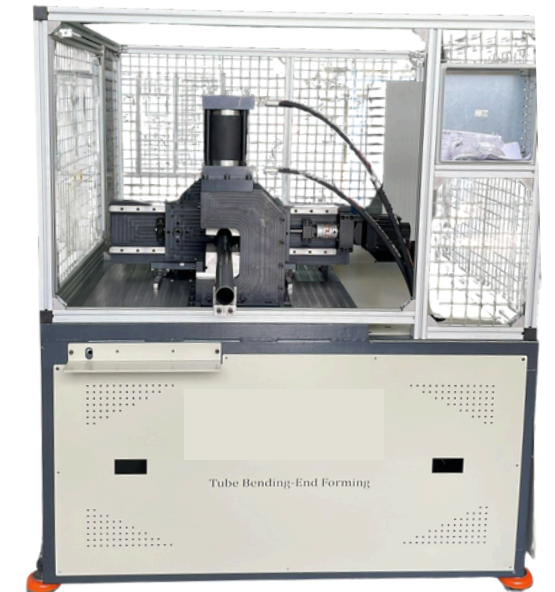

It is a high-power and flexible tool-compatible end forming machine designed for tube expanding and shrinking operations.

As AVERA BUKUM, we also manufacture products such as brackets and sheet metal on your products under the same roof in order to offer an integrated solution to our customers.

Guillotine Shears and Press Brakes



Hydraulic and Mechanical Presses (60 - 300 tons)



The shaping of the sheet metal materials on your product can be done within our company.

Our engineering team conducts advanced analysis and simulation studies to predict potential deformations during tube bending and forming processes and ensure production quality.

These studies evaluate critical parameters such as:

- Material flow and stress zones
- Wall thickness variations
- Springback effects and bending deviations
- Minimum bend radius verifications in a digital environment before production. This optimizes design and manufacturing strategies.

Furthermore, in line with customer demands and part geometries,

- Geometric criteria such as measurement angle, radius, wall thickness, and main axis are analyzed to technically assess process suitability and production capability before prototype and mass production.

This engineering infrastructure not only improves product quality but also provides time and cost savings during the production process.

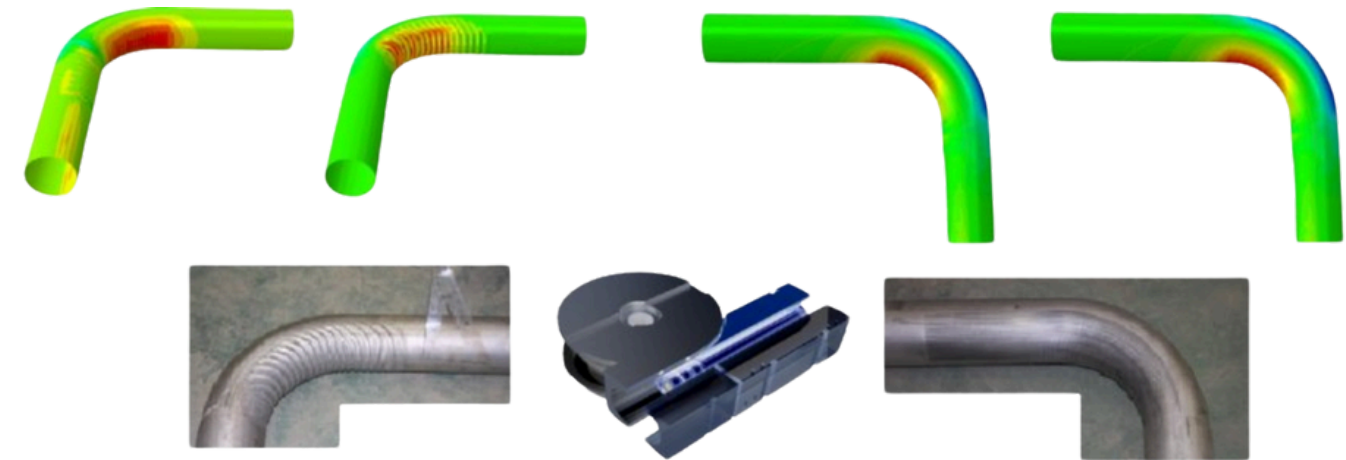
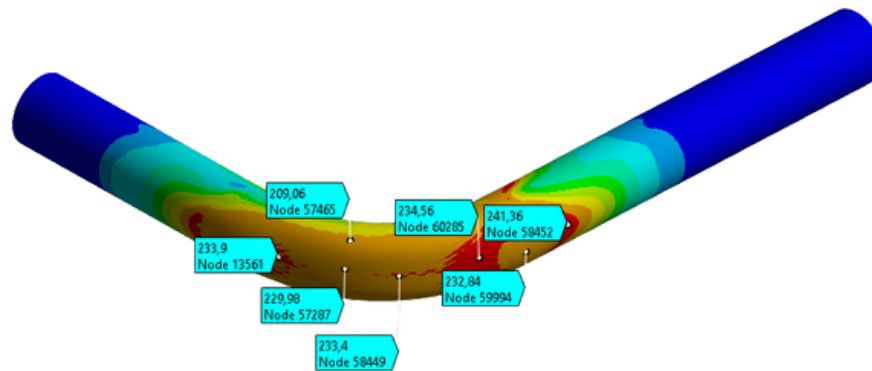

Avera				PARÇA				Avera				MAKİNA / KALIP				SONUÇLAR			
MODELLEME & ANALİZ VERİLERİ				TASARIM VERİLERİ				MODELLEME & ANALİZ VERİLERİ				MAKİNA / KALIP				SONUÇLAR			
TÜREY				TÜREY				TÜREY				TÜREY				TÜREY			
TÜREY				TÜREY				TÜREY				TÜREY				TÜREY			
TÜREY				TÜREY				TÜREY				TÜREY				TÜREY			
TÜREY				TÜREY				TÜREY				TÜREY				TÜREY			
TÜREY				TÜREY				TÜREY				TÜREY				TÜREY			
TÜREY				TÜREY				TÜREY				TÜREY				TÜREY			
TÜREY				TÜREY				TÜREY				TÜREY				TÜREY			
TÜREY				TÜREY				TÜREY				TÜREY				TÜREY			
TÜREY				TÜREY				TÜREY				TÜREY				TÜREY			
TÜREY				TÜREY				TÜREY				TÜREY				TÜREY			
TÜREY				TÜREY				TÜREY				TÜREY				TÜREY			
TÜREY				TÜREY				TÜREY				TÜREY				TÜREY			
TÜREY				TÜREY				TÜREY				TÜREY				TÜREY			
TÜREY				TÜREY				TÜREY				TÜREY				TÜREY			
TÜREY				TÜREY				TÜREY				TÜREY				TÜREY			
TÜREY				TÜREY				TÜREY				TÜREY				TÜREY			
TÜREY				TÜREY				TÜREY				TÜREY				TÜREY			
TÜREY				TÜREY				TÜREY				TÜREY				TÜREY			
TÜREY				TÜREY				TÜREY				TÜREY				TÜREY			
TÜREY				TÜREY				TÜREY				TÜREY				TÜREY			
TÜREY				TÜREY				TÜREY				TÜREY				TÜREY			
TÜREY				TÜREY				TÜREY				TÜREY				TÜREY			
TÜREY				TÜREY				TÜREY				TÜREY				TÜREY			
TÜREY				TÜREY				TÜREY				TÜREY				TÜREY			
TÜREY				TÜREY				TÜREY				TÜREY				TÜREY			
TÜREY				TÜREY				TÜREY				TÜREY				TÜREY			
TÜREY				TÜREY				TÜREY				TÜREY				TÜREY			
TÜREY				TÜREY				TÜREY				TÜREY				TÜREY			
TÜREY				TÜREY				TÜREY				TÜREY				TÜREY			
TÜREY				TÜREY				TÜREY				TÜREY				TÜREY			
TÜREY				TÜREY				TÜREY				TÜREY				TÜREY			
TÜREY				TÜREY				TÜREY				TÜREY				TÜREY			
TÜREY				TÜREY				TÜREY				TÜREY				TÜREY			
TÜREY				TÜREY				TÜREY				TÜREY				TÜREY			
TÜREY				TÜREY				TÜREY				TÜREY				TÜREY			
TÜREY				TÜREY				TÜREY				TÜREY				TÜREY			
TÜREY				TÜREY				TÜREY				TÜREY				TÜREY			
TÜREY				TÜREY				TÜREY				TÜREY				TÜREY			
TÜREY				TÜREY				TÜREY				TÜREY				TÜREY			
TÜREY				TÜREY				TÜREY				TÜREY				TÜREY			
TÜREY				TÜREY				TÜREY				TÜREY				TÜREY			
TÜREY				TÜREY				TÜREY				TÜREY				TÜREY			
TÜREY				TÜREY				TÜREY				TÜREY				TÜREY			
TÜREY				TÜREY				TÜREY				TÜREY				TÜREY			
TÜREY				TÜREY				TÜREY				TÜREY				TÜREY			
TÜREY				TÜREY				TÜREY				TÜREY				TÜREY			
TÜREY				TÜREY				TÜREY				TÜREY				TÜREY			
TÜREY				TÜREY				TÜREY				TÜREY				TÜREY			
TÜREY				TÜREY				TÜREY				TÜREY				TÜREY			
TÜREY				TÜREY				TÜREY				TÜREY				TÜREY			
TÜREY				TÜREY				TÜREY				TÜREY				TÜREY			
TÜREY				TÜREY				TÜREY				TÜREY				TÜREY			
TÜREY				TÜREY				TÜREY				TÜREY				TÜREY			
TÜREY				TÜREY				TÜREY				TÜREY				TÜREY			
TÜREY				TÜREY				TÜREY				TÜREY				TÜREY			
TÜREY				TÜREY				TÜREY				TÜREY				TÜREY			
TÜREY				TÜREY				TÜREY				TÜREY				TÜREY			
TÜREY				TÜREY				TÜREY				TÜREY				TÜREY			
TÜREY				TÜREY				TÜREY				TÜREY				TÜREY			
TÜREY				TÜREY				TÜREY				TÜREY				TÜREY			
TÜREY				TÜREY				TÜREY				TÜREY				TÜREY			
TÜREY				TÜREY				TÜREY				TÜREY				TÜREY			
TÜREY				TÜREY				TÜREY				TÜREY				TÜREY			
TÜREY				TÜREY				TÜREY				TÜREY				TÜREY			
TÜREY				TÜREY				TÜREY				TÜREY				TÜREY			
TÜREY				TÜREY				TÜREY				TÜREY				TÜREY			
TÜREY				TÜREY				TÜREY				TÜREY				TÜREY			
TÜREY				TÜREY				TÜREY				TÜREY				TÜREY			
TÜREY				TÜREY				TÜREY				TÜREY				TÜREY			
TÜREY				TÜREY				TÜREY				TÜREY				TÜREY			
TÜREY				TÜREY				TÜREY				TÜREY				TÜREY			
TÜREY				TÜREY				TÜREY				TÜREY				TÜREY			
TÜREY				TÜREY				TÜREY				TÜREY				TÜREY			
TÜREY				TÜREY				TÜREY				TÜREY				TÜREY			
TÜREY				TÜREY				TÜREY				TÜREY				TÜREY			
TÜREY				TÜREY				TÜREY				TÜREY				TÜREY			
TÜREY				TÜREY				TÜREY				TÜREY				TÜREY			
TÜREY				TÜREY				TÜREY				TÜREY				TÜREY			
TÜREY				TÜREY				TÜREY				TÜREY				TÜREY			
TÜREY				TÜREY				TÜREY				TÜREY				TÜREY			
TÜREY				TÜREY				TÜREY				TÜREY				TÜREY			
TÜREY				TÜREY				TÜREY				TÜREY				TÜREY			
TÜREY				TÜREY				TÜREY				TÜREY				TÜREY			
TÜREY				TÜREY				TÜREY				TÜREY				TÜREY			
TÜREY				TÜREY				TÜREY				TÜREY				TÜREY			
TÜREY				TÜREY				TÜREY				TÜREY				TÜREY			
TÜREY				TÜREY				TÜREY				TÜREY				TÜREY			
TÜREY				TÜREY				TÜREY				TÜREY				TÜREY			
TÜREY				TÜREY				TÜREY				TÜREY				TÜREY			
TÜREY				TÜREY				TÜREY				TÜREY				TÜREY			
TÜREY				TÜREY				TÜREY				TÜREY				TÜREY			
TÜREY				TÜREY				TÜREY				TÜREY				TÜREY			
TÜREY				TÜREY				TÜREY				TÜREY				TÜREY			
TÜREY				TÜREY				TÜREY				TÜREY				TÜREY			
TÜREY				TÜREY				TÜREY				TÜREY				TÜREY			
TÜREY				TÜREY				TÜREY				TÜREY				TÜREY			
TÜREY				TÜREY				TÜREY				TÜREY				TÜREY			
TÜREY				TÜREY				TÜREY				TÜREY				TÜREY			
TÜREY				TÜREY				TÜREY				TÜREY				TÜREY			
TÜREY				TÜREY				TÜREY				TÜREY				TÜREY			
TÜREY				TÜREY				TÜREY				TÜREY				TÜREY			
TÜREY				TÜREY				TÜREY				TÜREY				TÜREY			
TÜREY				TÜREY				TÜREY				TÜREY				TÜREY			
TÜREY				TÜREY				TÜREY				TÜREY				TÜREY			
TÜREY				TÜREY				TÜREY				TÜREY				TÜREY			
TÜREY				TÜREY				TÜ											

Specific Machinery and Equipment Production - AVERA R&D

Based on the requirements of our production processes, we design and manufacture bending dies, measuring fixtures, automation equipment, and special-purpose machines tailored to specific parts and operations.

Designs created in a 3D CAD environment are verified through simulation analysis and then processed into production on high-precision machines. Furthermore, production support units such as bending simulations, control fixtures, and welding apparatus are also developed within this framework.

This approach ensures full compliance with customer demands and maximizes efficiency in terms of production cycle times and quality control

- We can design and manufacture machinery within our own R&D department to produce even the most complex processes to meet our customers' specific demands and within the required tolerances. We are fully capable of designing and manufacturing in-house.

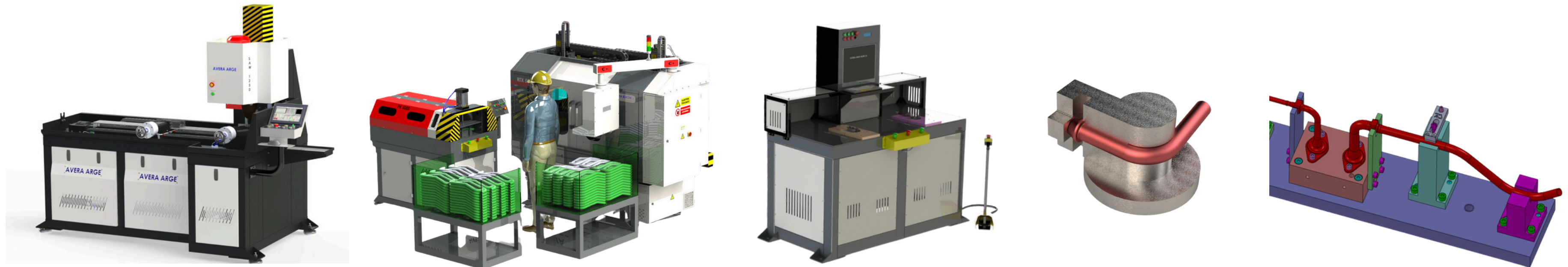

Quality and Measurement

3D scanning device performs three-dimensional scans of manufactured parts, and the resulting data is compared and analyzed with reference data using Geomagic ControlX software. This ensures error-free and highly accurate production. Additionally, reverse engineering is performed using Geomagic DesignX software, contributing to product development processes.

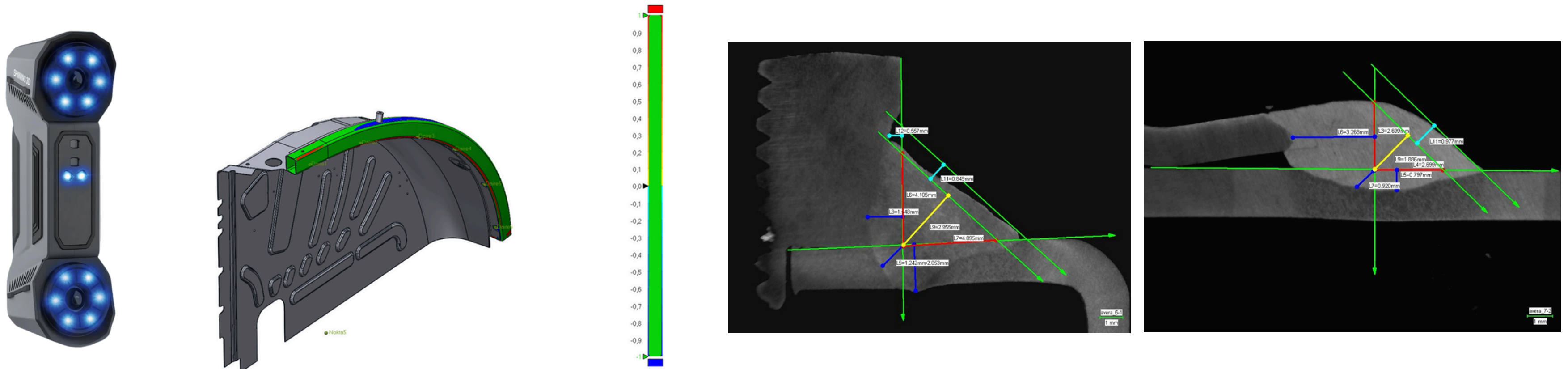

As part of the quality control of welded joints, macro-section preparation is performed, and samples are examined under a high-resolution stereomicroscope. The resulting images are used to perform critical measurements such as penetration, burn-in, bevel angles, line, and weld percentage, thus verifying weld quality.

We can design and manufacture machinery within our own R&D department to produce even the most complex processes to meet our customers' specific demands and within the required tolerances. We are fully capable of designing and manufacturing in-house.

AVRCUT1



Automatic Tube/Profile
Cutting Machine

AVRINS1

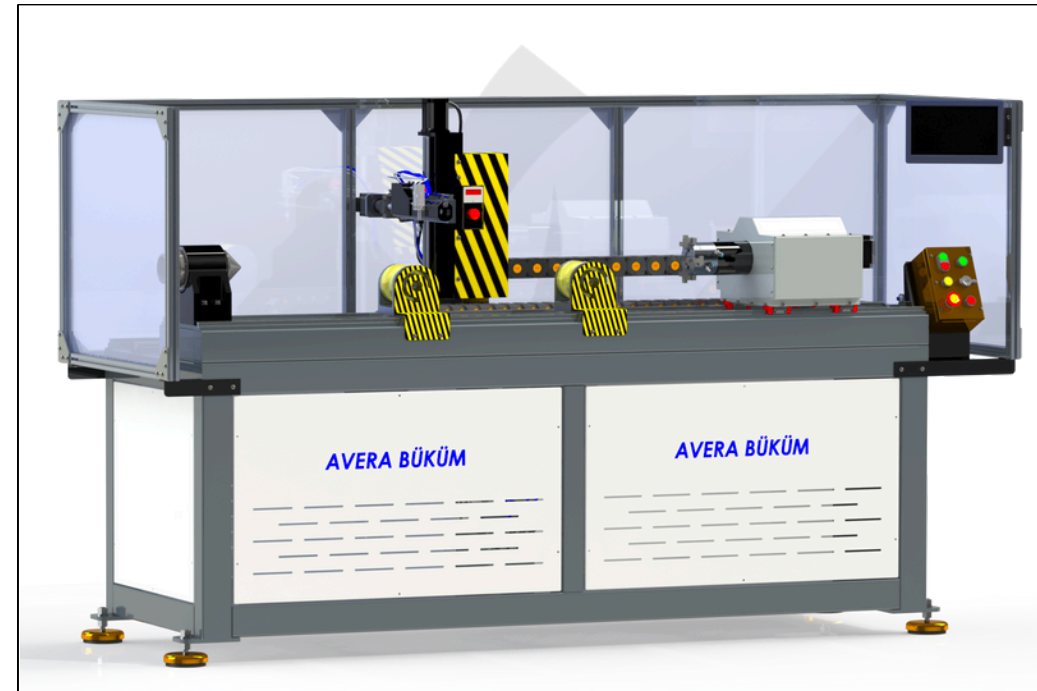

Automatic Tube (Hole and
Length) Inspection Machine

AVRML1

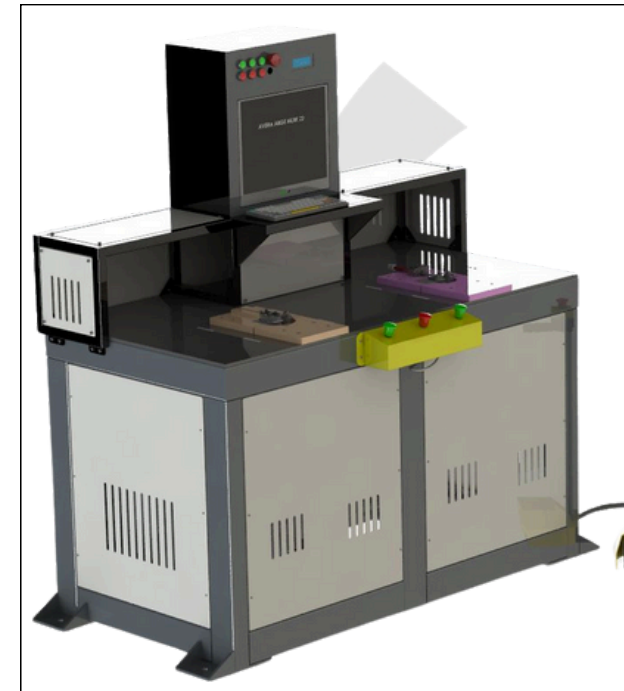

The CNC Shaft Bending
Machine

AVRCNC5X2



CNC Tube processing machine with
5 axis processing with 2 spindles

We can design and manufacture machinery within our own R&D department to produce even the most complex processes to meet our customers' specific demands and within the required tolerances. We are fully capable of designing and manufacturing in-house.

AVRPLS1

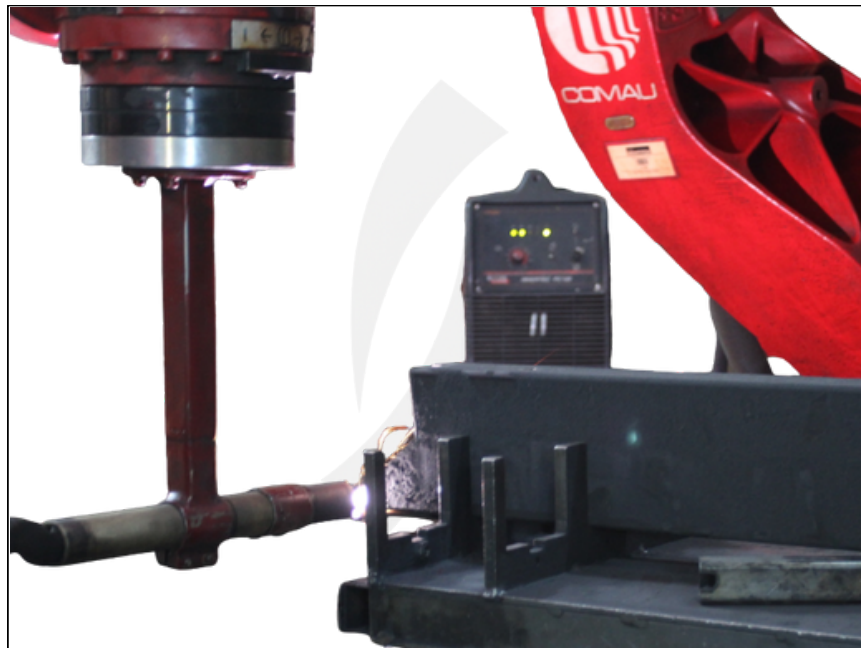

Plasma Cutting Robot

AVRBEV1



Tube Chamfering Machine

AVRDRL1



Tube Drilling Robot

Vehicles we add value to...



Brands we add value to...

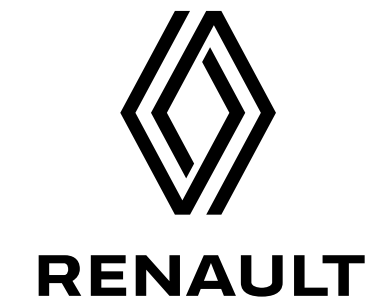

Our References



TürkTraktör



TREDİN

ANADOLU ISUZU

formiva



Get In Touch With Us.

Have Questions? We're Just a Message Away!

Contact Phone Number:



+90 224 411 24 43 / +90 224 482 52 52

E-mail Address:



info@averabukum.com

Address:



Avera Büküm San. Tic. Ltd. Şti. NOSAB Manolya Cd. No:10
Nilüfer/Bursa/TURKEY